

Name Of Work :-

Name of Work :- Constructing of Integrated Pack House for Vengurla
Producer Co. Ltd. At - Math, Tal - Vengurla. Dist. Sindhudurg

RECAPITULATION SHEET

1) Cost Of Work Portion

Rs 5676126.00

Add for Insurance

1% Rs 56761.26

Add for GST

18% Rs 1021702.68

Rs 6754589.94

Total Rs 6754589.94

Say Rs. **6754590.00**

Name Of Work :- Name of Work :- Constructing of Integrated Pack House for Vengurla
 Producer Co. Ltd. At - Math, Tal - Vengurla. Dist. Sindhudurg

ABSTRACT

Qty	Unit	Item Of Work	Rate	Per	Amount
141.22	Cum	Item No.1 :- Excavation for foundation in earth, soil of all types, sand, gravel and soft murum, including removing the excavated material up to a distance of 50 m. beyond the building area and stacking and spreading as directed, dewatering, preparing the bed for the foundation and necessary back filling, ramming, watering including shoring and strutting etc. complete. (Lift upto 1.5 m.) S.S.R.2022-2023 I/P 21.01/153			
					239.00
			Total Rs.		239.00
			Say Rs.		239.00
63.27	Cum	Item No.2:- Providing soling using 80 mm size trap metal in 15 cm. layer including filling voids with Crushed sand/grit, ramming, watering etc. complete. R.A. No.1	239.00	Cum	33751.58
66.14	Cum	Item No.3:- Providing and laying Cast in situ/Ready Mix cement concrete in M-10 of trap/ granite/ quartzite/ gneiss metal for foundation and bedding including bailing out water, formwork, laying/pumping, compacting, roughening them if special finish is to be provided, finishing if required and curing complete, with fully automatic micro processor based PLC with SCADA enabled reversible Drum Type mixer/concrete Batch mix plant (Pan mixer) etc. complete. With natural sand/V.S.I. quality Artificial Sand R.A. No.2	2541.10	Cum	160775.40
16.27	Cum	Item No.4:- Providing and laying in situ /Ready Mix cement concrete M-25 of trap / granite /quartzite/ gneiss metal for R.C.C. work in foundations like raft, strip foundations, grillage and footings of R.C.C. columns and steel stanchions etc. including bailing out water, Steel centering formwork, laying/pumping cover blocks, compaction and curing roughening the surface if special finish is to be provided (Excluding reinforcement and structural steel) etc. complete, with fully automatic micro processor based PLC with SCADA enabled reversible Drum Type mixer/ concrete Batch mix plant (Pan mixer) etc. complete. With fine aggregate (Natural Sand / Crushed sand VSI Grade finely washed etc) R.A. No.3	6957.20	Cum	460149.21
			8252.60	Cum	134269.80

Qty	Unit	Item Of Work	Rate	Per	Amount
18.41	Cum	<p>Item No.5:-Providing and laying Cast in situ/Ready Mix cement concrete M-25 of trap / granite /quartzite/ gneiss metal for R.C.C. columns as per detailed designs and drawing or as directed including steel centering, formwork, cover blocks, laying/pumping, compaction finishing the formed surfaces with cement mortar 1:3 of sufficient minimum thickness to give a smooth and even surface or roughening if special finish is to be provided and curing etc. complete,(Excluding reinforcement and structural steel).with fully automatic micro processor based PLC with SCADA enabled reversible Drum Type mixer/ concrete Batch mix plant (Pan mixer) etc. complete. With fine aggregate (Natural Sand / Crushed sand VSI Grade finely washed etc)</p> <p>R.A. No.4</p>	15087.80	Cum	277766.40
50	Cum	<p>Item No.6:-Providing and laying Cast in situ/Ready Mix cement concrete M-25 of trap / granite /quartzite/ gneiss metal for R.C.C. beams and lintels as per detailed designs and drawings or as directed including centering, formwork, cover blocks, laying/pumping, compaction and roughening the surface if special finish is to be provided and curing etc. complete. (Excluding reinforcement and structural steel). with fully automatic micro processor based PLC with SCADA enabled reversible Drum Type mixer/ concrete Batch mix plant (Pan mixer) etc. complete. With natural sand/V.S.I. quality Artificial Sand 189/25.50 6741.00</p> <p>R.A. No.5</p>	13572.80	Cum	427543.20
4	Cum	<p>Item No.7:-Providing and laying Cast in situ/Ready Mix cement concrete M-25 of trap / granite /quartzite/ gneiss metal for R.C.C. Slab as per detailed designs and drawing or as directed including centering, formwork, cover blocks, laying/pumping, compaction finishing the formed surfaces with cement mortar 1:3 of sufficient minimum thickness to give a smooth and even surface or roughening if special finish is to be provided and curing etc. complete,(Excluding reinforcement and structural steel).with fully automatic micro processor based PLC with SCADA enabled reversible Drum Type mixer/ concrete Batch mix plant (Pan mixer) etc. complete. With natural sand/V.S.I. quality Artificial Sand</p> <p>R.A. No.6</p>	15236.80	Cum	87459.23

Qty	Unit	Item Of Work	Rate	Per	Amount
1.75	Cum	Item No.8:- Providing and laying Cast in situ/Ready Mix cement concrete M-25 of trap / granite /quartzite/ gneiss metal for R.C.C. chajja as per detailed designs and drawing or as directed including centering, formwork, cover blocks, laying/pumping, compaction finishing the formed surfaces with cement mortar 1:3 of sufficient minimum thickness to give a smooth and even surface or roughening if special finish is to be provided and curing etc. complete,(Excluding reinforcement and structural steel).with fully automatic micro processor based PLC with SCADA enabled reversible Drum Type mixer/ concrete Batch mix plant (Pan mixer) etc. complete. With natural sand/V.S.I. quality Artificial Sand			
		R.A. No.7	15236.80	Cum	26664.40
6.26	M.T.	Item No.9:- Providing and fixing in position TMT - FE - 500 bar reinforcement of various diameters for R.C.C. pile caps, footings, foundations, slabs, beams columns, canopies, staircase, newels, chajjas, lintels pardis, copings, fins, arches etc. as per detailed designs, drawings and schedules. including cutting, bending, hooking the bars, binding with wires or tack welding and supporting as required complete.			
		R.A. No.8	89868.00	M.T.	562753.42
22.00	Cum	Item No.10 :- Providing laterite stone masonry in cement mortar 1:6 in Foundation including racking out joints where plastering is to be done watering and scaffolding complete. (Laterite stone six sides cut and thickness of mortar joints shall be 12mm max.)			
		R.A. No.9	6306.70	Cum	138736.46
74.12	Cum	Item No.11 :- Providing laterite stone masonry in cement mortar 1:6 in Superstructure including racking out joints where plastering is to be done watering & scaffolding complete.			
		R.A. No.10	6994.70	Cum	518447.16
20.37	Sqm.	Item No.12:- Providing internal cement plaster 6mm thick in a single coat in cement mortar 1:4 without neeru finish to concrete surface in all positions including scaffolding and curing etc. complete.			
		R.A. No.11	214.30	Sqm.	4365.72
1053.13	Sqm.	Item No.13:- Providing internal cement plaster 20mm thick in single coats in cement mortar 1:4 without neeru finish, to concrete, brick surface, in all positions including scaffolding and curing etc.complete.			
		R.A. No.12	398.80	Sqm.	419990.16

Qty	Unit	Item Of Work	Rate	Per	Amount
405.42	Sqm.	Item No.14 :- Providing sand faced plaster externally in cement mortar using approved screened sand, in all positions including base coat of 15 mm thick in cement mortar 1:4 using waterproofing compound at 1 kg per cement bag curing the same for not less than 2 days and keeping the surface of the base coat rough to receive the sand faced treatment 6 to 8 mm thick in cement mortar 1:4 finishing the surface by taking out grains and curing for fourteen days scaffolding etc.complete. R.A. No.13	661.50	Sqm.	268182.22
16.09	Sqm.	Item No.15 -Providing and fixing green marble of 18to20mm thick for door frame/ dado/ window boxing etc. On C.M.1:6 including filling joints with polymer base filler nosing/ moulding the sharp edges wherever necessary, curing, etc. complete. R.A. No.14	2381.00	Sqm.	38315.05
26.38	Sqm.	Item No.16 -Providing and laying vitrified mirror/glosy finish tiles having size 590mm to 605mm x to 605mm of 8to10mm thickness and confirming IS.15622-2006(GroupBla) of approved make,shade and pattern for flooring in required position laid on a bed of 1:4 cement morar including neat cement float, filling joints, curing and cleaning etc. complete. a) Flooring R.A. No.15	1187.50	Sqm.	31326.25
2.97	Sqm.	Item No.17 :-Providing and laying machine cut machine polished machine cut Kota stone slabs 20 to 25 mm thick for treads and risers of steps and staircases, with rounded nosing for the treads on a bed of 1:4 cement mortar including cement float, filling joints with neat cement slurry, curing, polishing and cleaning etc. complete. R.A. No.16	1584.40	Sqm.	4705.67
280.62	Sqm.	Item No.18 :-Providing and laying machine cut machine Polished Kota stone flooring 25mm to 30mm thick and required width in plain/ diamond pattern on bed of 1:6 C. M. including cement float, filling joints with neat cement slurry, curing, polishing and cleaning etc. complete. R.A. No.17	1260.60	Sqm.	353752.47

Qty	Unit	Item Of Work	Rate	Per	Amount
0.38	Cum	Item No.19:- Providing and fixing frame with / without ventilator of size as specified with Country cut teak wood for doors and windows including chamfering, rounding, rebating, iron holdfast of size 300mm x 40mm x 5mm with oil painting, etc. complete			
		S.S.R.S.S.R.2022-2023 I/P 39.01/245	200050.0		
		Total Rs.	200050.0		
		Say Rs.	200050.0	200050.00	Cum
23.94	Sqm.	Item No.20:- Providing and fixing Country cut teak wood double or single leaf second class fully panelled door shutter with 35mm thick style and rail with 25 mm thick panels with openable fan light as per detailed drawings. Excluding the door frame 60mm x 100mm stainless steel fixtures and fastening and finishing the wood work with oil painting 3 coats. (Excluding the door frame)			
		S.S.R.2022-2023 I/P 39.04/245	9574.00		
		Total Rs.	9574.00		
		Say Rs.	9574.00	9574.00	Sqm.
0.96	Sqm.	Item No.21 :- Providing and fixing in position powder coated aluminium louvered windows / ventilator of various sizes with powder coating as per detailed drawing and specifications including aluminium frames 80 x 38 mm x 1.22 mm box type, 5 mm thick sheet glass louvers, of approved quality etc. complete.			
		S.S.R.2022-2023 I/P 39.68/188	3467.00		
		Total Rs.	3467.00		
		Say Rs.	3467.00	3467:00	Sqm.
14.40	Sqm.	Item No.22 :- Providing and fixing in position. (asper I.S.1868/1982) Aluminium sliding window of three tracks with rectangular pipe having overall dimension 63.50x38.10x1.02mm at weigh t0 .547kg/Rmt. and window frame bottom track section 61.85x31.75x1.20mm at weight 0.695kg/Rmt. To pand side track section 61.85x31.75x1.30mm at weight0.659kg/Rmt. The shutter should be of bearing bottom 40x18x1.25mm at weight0.417kg/Rmt. Interlocking section 40x18x1.10mm at weight 0.469kg/Rmt. And handle section 40x18x1.25mm at weight 0.417kg/Rmt. and top section 40x18x1.25mm at weight 0.417kg/Rmt. As per detailed drawings and as directed by Engineer incharge with all necessary Aluminium sections fixtures and fastenings such as roller bearing in nylon casting and self locking catch fitted in vertical section of shutter including 5mm thick plain glass with all required screws and nutsetc, complete. With powder coating with box			
		S.S.R.2022-2023 I/P 39.39/252	5284.00		
		Total Rs.	5284.00		
		Say Rs.	5284.00		

Qty	Unit	Item Of Work	Rate	Per	Amount
15.36	Sqm.	<p>Item No.23 :-Providing and fixing mild steel grill work for windows, ventilators, etc. 15 kg/sqm as per drawing including fixtures necessary welding and painting with one coat of anticorrosive paint and two coats of oil painting complete.</p> <p>S.S.R.2022-2023 I/P 40.02/264</p> <p style="text-align: right;">1707.00</p> <p style="text-align: right;">Total Rs. 1707.00</p> <p style="text-align: right;">Say Rs. 1707.00</p>			
5.25	Sqm.	<p>Item No.24:-Providing and fixing rolling shutter fabricated from steel laths of minimum thickness 0.9 mm with lock plate of 3.15 mm thickness reinforced with 35 x 35 x 5 mm angle section fitted with sliding bolts and handles for both sides, deep M.S. channel section of depth and thickness not less than 65 mm and 3.15 mm respectively with hold fast arrangements, M.S. Bracket plate 300 x 300 x 3.15 mm minimum size and shape with square bar, suspension shaft of minimum 32 mm diameter, hood cover of M.S. sheet not less than 0.9 mm thickness and of any size at top and safety devices including mechanical gear operation arrangement consisting of worm gear wheels and worms of high grade cast iron or mild steel and one coat of red lead primer etc. complete. (I.S. 62481979) (Without mechanical gear)</p> <p>S.S.R.2022-2023 I/P 39.24/248</p> <p style="text-align: right;">4829.00</p> <p style="text-align: right;">Total Rs. 4829.00</p> <p style="text-align: right;">Say Rs. 4829.00</p>	1707.00	Sqm.	26219.52
2.00	No.	<p>Item No.25:-Providing and fixing European type white glazed earthenware coupled closet symphonic trap with symphonic low level white glazed 10 litres cistern with black backlite seat with all necessary pipe connection etc. complete.</p> <p>R.A. No.18</p>	4829.00	Sqm.	25352.3
1.00	No.	<p>Item No.26 :-Providing and fixing white glazed earthenware lipped flat back/corner type Urinal with PVC 5liters flushing cistern with fittings, inlet pipe with stop tap, brackets for fixing the cistern, 32mm diameter P.V.C. flush pipe with fitting including leads oil pipe, lead trap and soil pipe connection up to the outside face of wall.</p> <p>R.A. No.19</p>	11223.70	No.	22447.40
			4795.00	No.	4795.00

Qty	Unit	Item Of Work	Rate	Per	Amount
2.00	No.	Item No.27 :-Providing and fixing White glazed with bottle trap earthenware Wash Hand Basin of 55x40 cm size including cold water pillar taps, brackets, rubber plugs and brass chain, stop tap, chromium plate bottle trap and necessary pipe connections including UPAC waste pipe and trap upto the outside face of the wall, making good the damaged surface, testing etc. complete. R.A. No.20			
			6480.00	No.	12960.00
2	No.	Item No.28 :-:Providing and fixing 10 cm.PVC nahani trap with grating etc. complete. R.A. No.21			
			546.80	No.	1093.60
2	No.	Item No.29 :-Providing and constructing Brick Masonry Inspection Chamber 60cm x 45cm x 90cm including 1:4:8 cement concrete foundation 1:2:4 cement concrete channels half round G.S.W. pipes, Brick Masonry, plastering from inside and airtight C. I. cover* of 75 kg with lid and frame fixed in cement concrete. R.A. No.22			
			9568.50	No.	19137.00
1.00	No.	Item No.30 :Providing soak pit of size 120cm x 120cm x 120cm including excavating and filling with brick-bats. S.S.R.2022-2023 I/P 42.19/275 Total Rs. Say Rs.			
					2952.00
					2952.00
					2952.00
			2952.00	No.	2952.00
3	No.	Item No.31 :- Providing and Fixing half turn 25mm dia gun metal flushing cock including all accessories etc. complete. S.S.R.2022-2023 I/P 42.32/277 Total Rs. Say Rs.			
					953.00
					953.00
					953.00
			953.00	No.	2859.00
2	No.	Item No.32 :-Providing and fixing C.P. Angular stop clock with wall flange of approved make continental including necessary sockets/union nut S.S.R.2022-2023 I/P 42.79/282 Total Rs. Say Rs.			
					2687.00
					2687.00
					2687.00
			2687.00	No.	5374.00
3	No.	Item No.33 :-Providin gandfixing C.P. BIB cock with wall flange of approved make including necessary sockets/ union nut etc. complete. S.S.R.2022-2023 I/P 42.83/283 Total Rs.			
					1108.00
					1108.00

Qty	Unit	Item Of Work	Rate	Per	Amount
2	No.	Item No.34:- Providing and fixing C.P. pillar cock long neck with aerator of approed make including necessary sockets/union nut etc. complete. S.S.R.2022-2023 I/P 42.82/282 1625.00 Total Rs. 1625.00 Say Rs. 1625.00			
2.00	No	Item No.35 :- Providing and fixing screw down for 40mm dia.wheeled stop tap of brass including necessary sockets/ union nut complete. S.S.R.2022-2023 I/P 41.47/270 1171.00 Total Rs. 1171.00 Say Rs. 1171.00	1625.00	No.	3250.00
1000.00	Lit.	Item No.36 :- Providing and fixing H.D.Pcontainer Syntex or alike one piece moulded water tank made out of high density polythylar and built corrugated inclusive of delivery upto destination hoisting and fixing of accessories such as inlet,outlet over flow pipe inclusive of all tanks capacity between 200 to 1000 liters S.S.R.2022-2023 I/P 42.54/280 11.00 Total Rs. 11.00 Say Rs. 11.00	1171.00	No	2342.00
1.00	No	Item No.37 :- Providing and fixing hume pipe septic tank 900mm diameter with vent pipe and cap including necessary (including excavation and lavine) S.S.R.2022-2023 I/P 42.18/275 16726.00 Total Rs. 16726.00 Say Rs. 16726.00	11.00	Lit.	11000.0
405.42	Sqm.	Item No.38:- Providing and applying two coats of exterior acraylic emulsion paint confirming to corresponding I.S. of approved manufacture and of approved colour to the plastered surfaces including cleaning, preparing the plaster surface,a pplying primer coat, scaffolding if necessary , and watering the surface for two days etc complete. S.S.R.2022-2023 I/P 35.25/225 261.00 Total Rs. 261.00 Say Rs. 261.00	16726.00	No	16726.0
1073.50	Sqm.	Item No.39- Providing and applying washable oil bounddistemper of approved colour and shade to old and new surfaces in two coats including scaffolding, preparing the surfaces. (including the primer coat.) etc.complete S.S.R.2022-2023 I/P 36.11/227 48.00	261.00	Sqm.	105814.62

Qty	Unit	Item Of Work	Rate	Per	Amount
		S.S.R.2022-2023 I/P 35.21/225	36.00		
		Total Rs.	84.00		
		Say Rs.	84.00		
59.10	Sqm.	Item No.40 :- Providing and applying Two coats of wall care Putty on plastered surface and Ceiling and Walls to prepare surface even and smooth of approved make, etc complete.	84.00	Sqm.	90174.00
		S.S.R.2022-2023 I/P 32.34/212	90.00		
		Total Rs.	90.00		
		Say Rs.	90.00		
443.83	Sqm.	Item No.41 :-Providing and fixing of colour coated Zinc aluminium (R) AZ150 (min150 gms/sq.mt. total on each side) profiled sheets for roofing. The feed material is manufactured out of nominal 0.45 mm Base Metal Thickness (BMT) (0.5mmTCT), Hi-strength steel with min. 550MP ayield strength, metallic hqt dipcoated with Aluminium-Zincalloy (55% aluminiumm 43.4% zinc 1.6% silicon) with COLORBOND (R) steel quality super durable polyster paint coat (with in organic pigment). The paint shall have a total coating thickness of nominal 35um, comprising of nominal 25um exterior coat on top surface and nominal 10um reverse coat on back surface. Profile sheet shall have nom. 950-1050 mm effective cover width and nominal 25-30mm deep ribs with subtle square fluting in the five pan at nominal 180-250mm center -to-center. The end rib shall be designed for anti-capacity groove. and return leg. The feed material should have coil manufacturers product details marked a regular interval. including fasteners with min.fastened with min. 25 umZinc- Tinalloy coated, Hexhead, self-drill ling screw etc. complete.(weight of profile 4.52kg/sqm)	90.00	Sqm.	5319.00
		S.S.R.2022-2023 I/P 38.34/236	1173.00		
		Total Rs.	1173.00		
		Say Rs.	1173.00		
			1173.00	Sqm.	520612.59

Qty	Unit	Item Of Work	Rate	Per	Amount						
3.37	M.T.	<p>Item No.42 :-Providing structural steel work in trusses, other similar trussed purlins and members with all bracing, gusset plates etc. as per detailed designs and drawings or as directed including cutting, fabricating, hoisting, erecting fixing in position, Making riveted/ bolted/ welded connection and one coat of anticorrosive paint and over it 2 coats of oil painting approved quality and shade etc. complete</p> <p>S.S.R.2022-2023 I/P 23.04/173</p> <table border="1" style="width: 100%; margin-left: auto;"> <tr> <td style="width: 80%;"></td> <td style="text-align: right;">119459.00</td> </tr> <tr> <td style="text-align: right;">Total Rs.</td> <td style="text-align: right;">119459.00</td> </tr> <tr> <td style="text-align: right;">Say Rs.</td> <td style="text-align: right;">119459.00</td> </tr> </table>		119459.00	Total Rs.	119459.00	Say Rs.	119459.00			
	119459.00										
Total Rs.	119459.00										
Say Rs.	119459.00										
1.00	No	<p>Item No.43 :- Providing lettering name board on plastered surface of wall</p> <p>Painter - I/P- 10/386 641.00 Oil Paint - P/I - 1/372 <u>292.00</u> Total Rs 933.00</p>	119459.00	M.T.	402411.98						
			933.00	No	933.00						
06.12	Cum	<p>Item No.44:- Royalty charges</p> <p>1)Laterie stone</p>	216.18	Cum	20778.85						
57.15	Cum	2)Sand	237.37	Cum	15939.66						
53.27	Cum	2)Trap rubble	216.18	Cum	13677.71						
1	No.	<p>Item No.45 Testing charges for materials as per frequency chart</p> <p>Cement Concrete M-20 Compressive test</p>	690.00	No.	690.00						
1	No.	<p>Steel - Weight per meter</p> <p>Cement</p>	400.00	No.	400.00						
1	No.	<p>(1) Standard consistency, Fineness, Specific gravity, Setting time, Compressive Strength, Soundness</p>	3770.00	No.	3770.00						
1	No.	<p>Sand</p> <p>(1) Sieve analysis.</p>	1380.00	No.	1380.00						

Total Rs. 5676125.66
Say Rs. 5676126.00

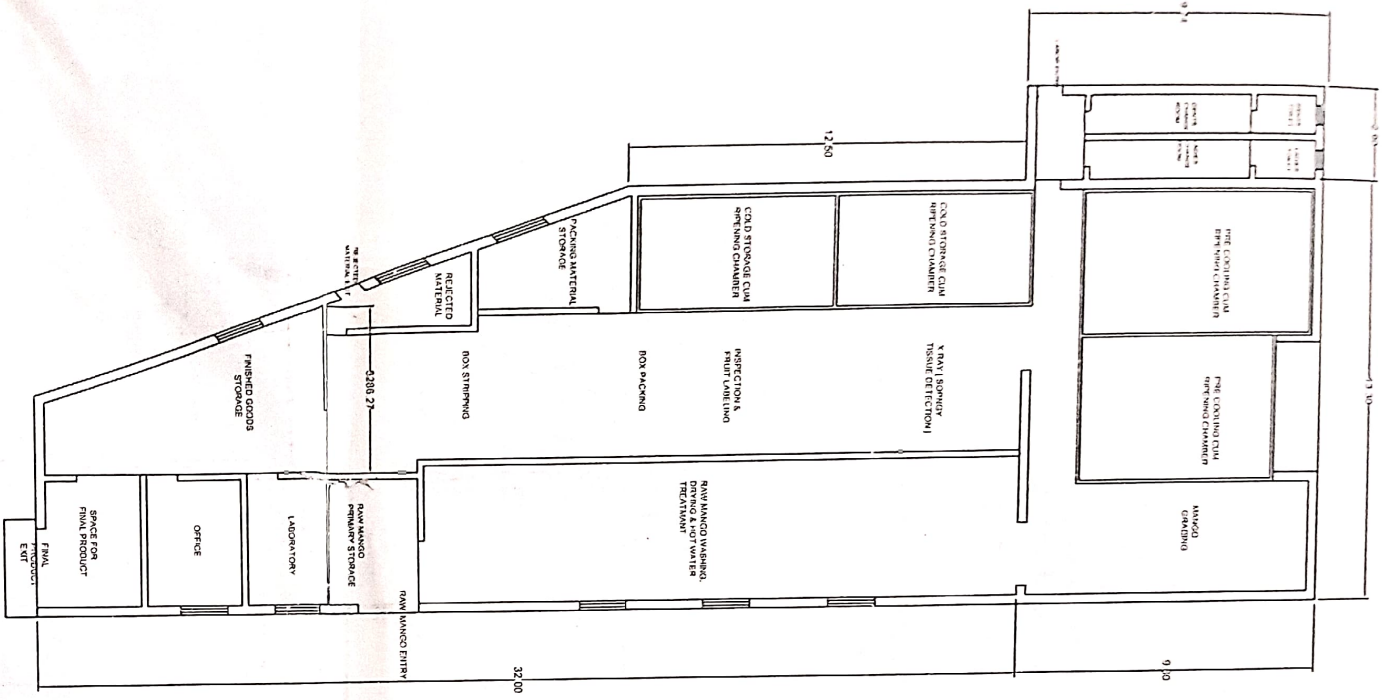

LAYOUT

